



Hahn KT-Bohrlehre

Hahn KT Gabarit de perçage • Hahn KT Drilling jig

Vorbereitung • Préparation • Preparation

Für Hahn KT-V 6R/KT-EV/KT-SV • Pour Hahn KT-V 6R/KT-EV/KT-SV • For KT-V 6R/KT-EV/KT-SV

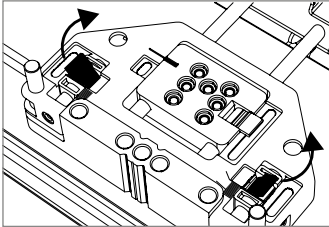

Klemmhebel lösen
Ouvrir les leviers de blocage
Loosen clamp lever

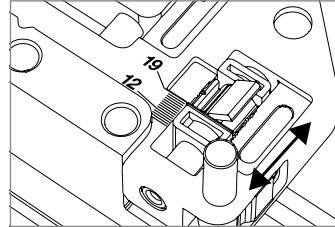

Anschlag für Rahmenbohrmaß gemäß Hahn-Einbauzeichnung (Skala 9–22 mm) einstellen
Régler les butées de cote dormant suivant plan Hahn (graduation de 9 à 22 mm)
Adjust depth gauge for drilling according to the installation drawing (scale 9–22 mm)

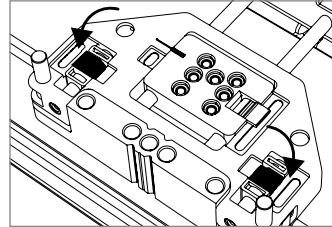

Klemmhebel schließen
Verrouiller les leviers de blocage
Close clamp lever

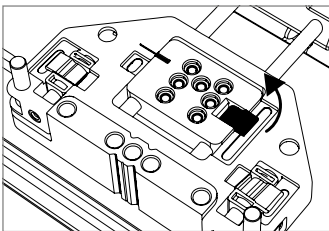

Klemmhebel lösen
Ouvrir les leviers de blocage
Loosen clamp lever

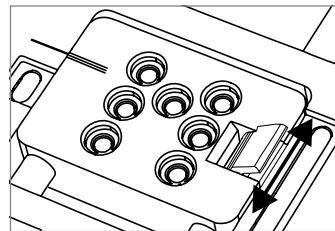

Bohrplatte gemäß Hahn-Einbauzeichnung (Skala 46/47/48 mm) einstellen
Régler plaque de perçage suivant plan Hahn (graduation 46/47/48 mm)
Adjust depth gauge for drilling according to the installation drawing (scale 46/47/48 mm)

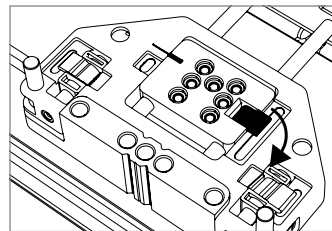

Klemmhebel schließen
Verrouiller les leviers de blocage
Close clamp lever

Einstellen der Bohrlehre • Réglage du gabarit • Adjust the drilling jig

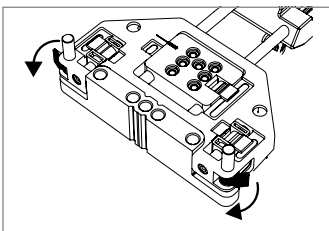

Klemmhebel lösen
Ouvrir les leviers de blocage
Loosen clamp lever

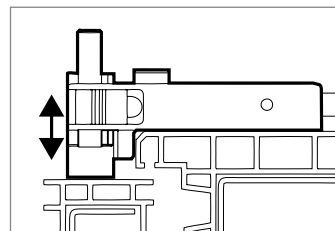

Bohrlehre auf Profil aufsetzen
Poser le gabarit sur les profils
Fix the drilling jig onto the profile

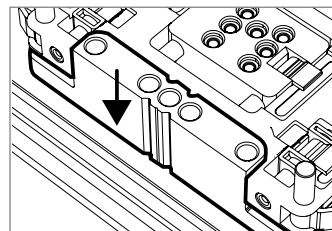

Aufdeck mit Rahmenbohrplatte einstellen
Régler le recouvrement avec la plaque de perçage dormant
Adjust upstand with sash drilling plate

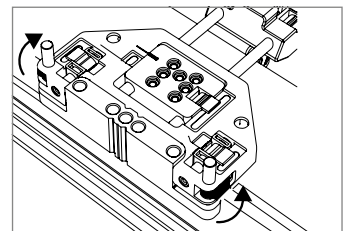

Klemmhebel schließen
Verrouiller les leviers de blocage
Close clamp lever

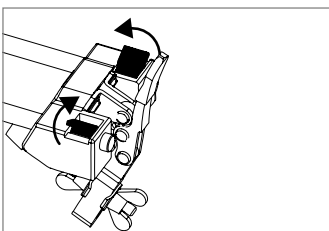

Klemmhebel lösen
Ouvrir les leviers de blocage
Loosen clamp lever

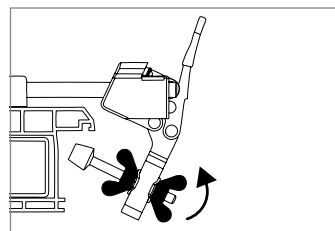

Flügelschrauben lösen
Desserrer les écrous papillon
Loosen butterfly screw

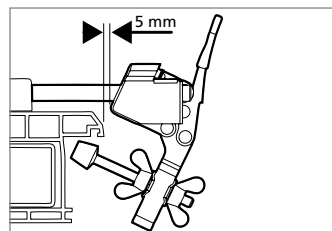

Spannvorrichtung in Position bringen (ca. 5 mm vom Profil entfernt)
Amener la sauterelle de serrage en position (environ 5 mm en retrait du profil)
Bring fastening device into position (approx. 5 mm away from profile)

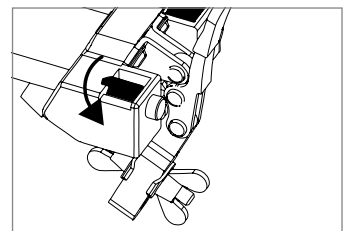

Klemmhebel schließen
Verrouiller les leviers de blocage
Close clamp lever



Hahn KT-Bohrlehre

Hahn KT Gabarit de perçage • Hahn KT Drilling jig

Einstellen der Bohrlehre • Réglage du gabarit • Positioning of the drilling jig

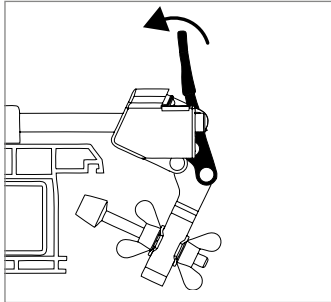

Spannhebel nach vorne setzen
Positionner le levier de sauterelle vers l'avant
Move clamp lever forwards

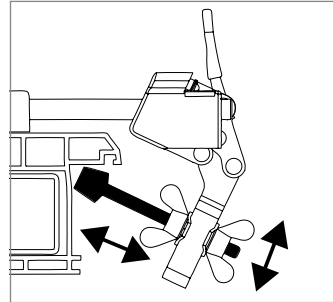

Stößel an Überstand in Position bringen
Amener le butoir en position
Position the tappet rod onto the upstand

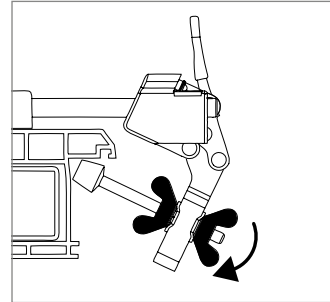

Flügelschrauben festsetzen
Serrer les écrous papillon
Fasten butterfly screw

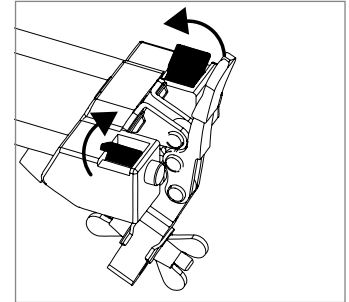

Klemmhebel lösen
Ouvrir les leviers de blocage
Loosen clamp lever

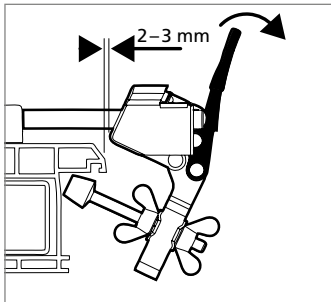

Spannhebel lösen und Schnellspannvorrichtung 2-3 mm an Profil heran schieben
Ramener le levier de sauterelle vers l'arrière et faire glisser l'ensemble de serrage rapide de 2 à 3 mm vers le profil
Loosen clamp lever and position quick fastening device 2-3 mm onto profile

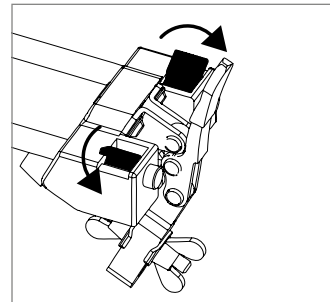

Klemmhebel schließen
Verrouiller les leviers de blocage
Close clamp lever

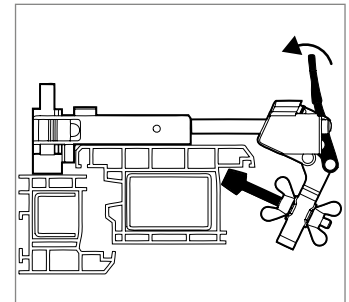

Bohrplatte mit Spannhebel klemmen
Bloquer le gabarit avec la sauterelle
Clamp drilling plate with tension lever

Bohren Anwendungsbereiche • Perçage champ d'application • Drilling application area

Bohrbilder
(Darstellung DIN links)
Plan de perçage
(Illustration DIN gauche)
Drilling template
(pictured DIN left)

