

GUIDA CHIUSA

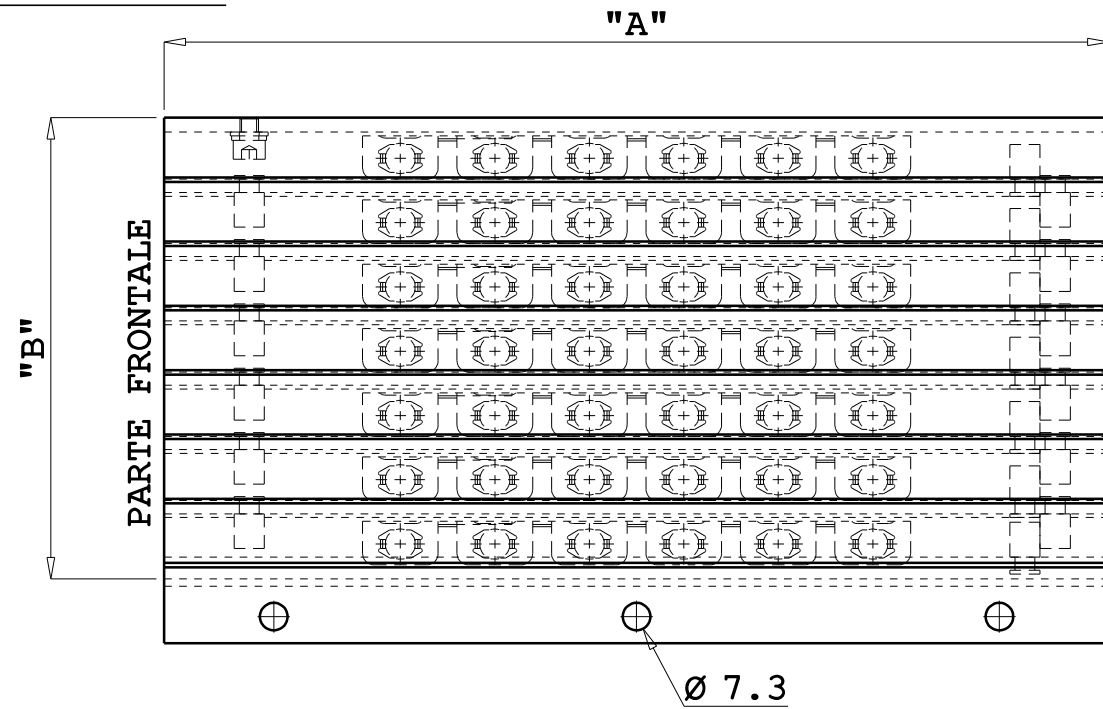

SEZIONE

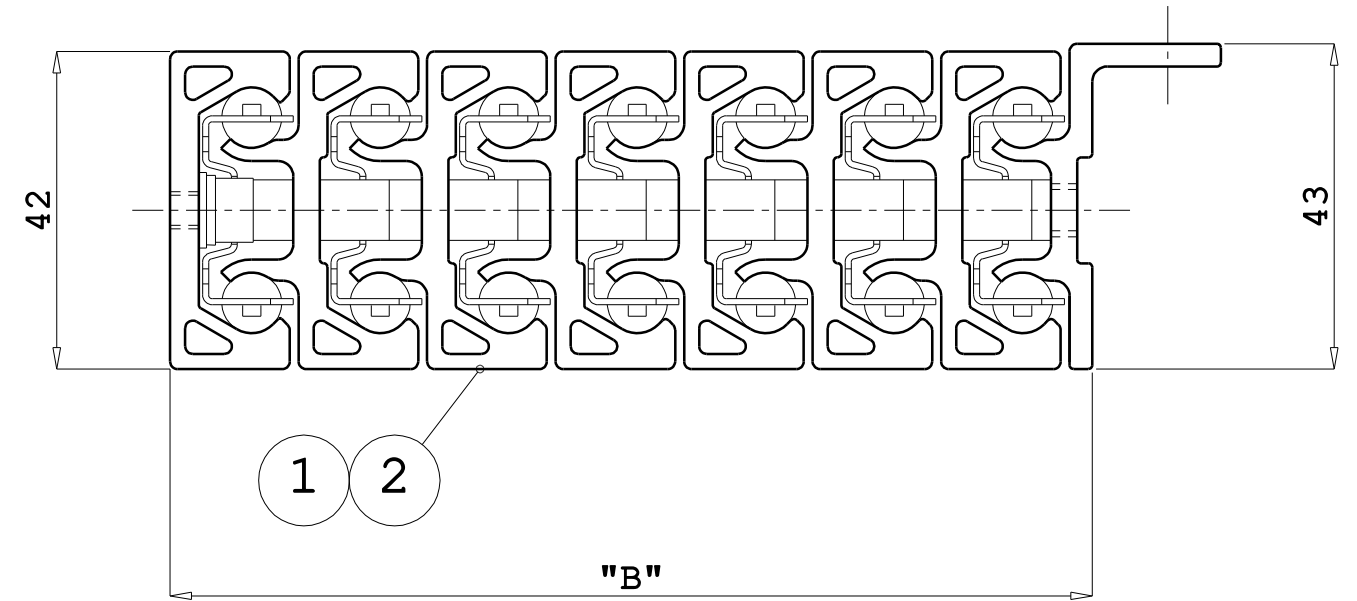

GUIDA APERTA

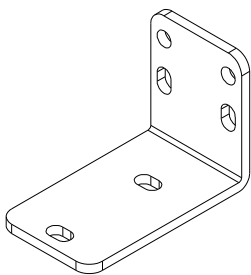
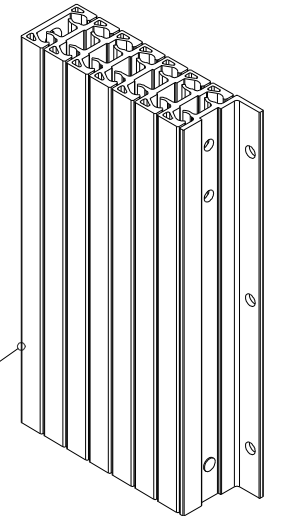
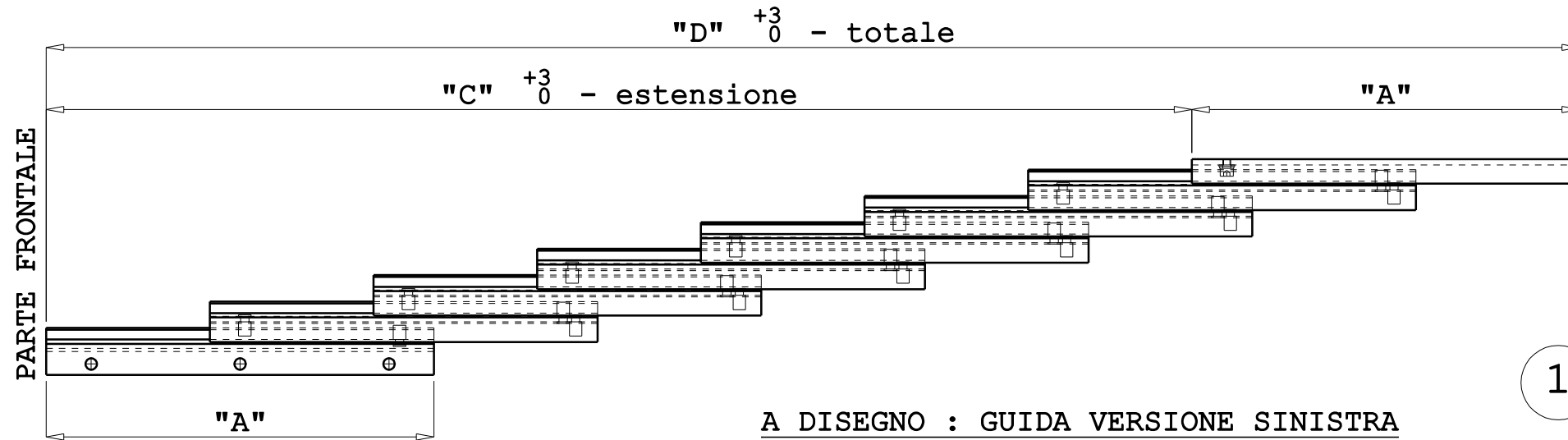

3



4

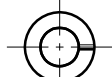
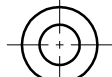
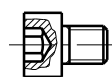

Inserire nella scatola foglio istruzioni guida e foglio polietilene per le guide

N.POS.	DENOMINAZIONE PARTICOLARE	N. PEZZI	CODICE PARTICOLARE	DISEGNO N.
04	GRP. VITI FISSAGGIO	1	09347/000/00/0000/61	18300
03	GRP. STAFFA + VITI	1	09347/000/00/0000/60	18299
02	GRP. GUIDA COMPLETA SX	1	09347/010/00/----/52	18345
01	GRP. GUIDA COMPLETA DX	1	09347/010/00/----/51	18298

Data	Firma	TOLLERANZE GENERALI		LUNGH. e DIAMETRI	ANGOLI
Disegnato 09-04-18	Beretta	LUNGH. e >18 <18 ± 0.15		<80 ± 0.25	ANGOLI ± 30'
Visto 09-04-18		DIAMETRI >80 ± 0.50		>80 ± 0.50	
Modifica 1 29-05-18	Beretta	Modificato viti per fissaggio staffa + allargato fori da Ø7.1 a Ø7.3 mm.			
Visto 29-05-18					
Modifica 2 23-10-18	Beretta	Modificato distanza fori Ø7 mm. su squadra			
Visto 23-10-18					
Modifica 3 30-11-18	Beretta	Aggiunto lunghezza da 470 mm.			
Visto 30-11-18					
Modifica 4 30-01-19	Beretta	Diversificato disegno tra destro e sinistro			
Visto 30-01-19					
Modifica 5					
Visto					

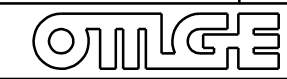

Denominazione
ART.09347/000/00/----/00
ASSIEME GUIDA
 N. Disegno
4 / 18292
 SCALA
 1:1
 1:2

CODICE ASSIEME	CODICE POS.01	CODICE POS.02	LUNGH. A mm.	LUNGH. B mm.	LUNGH. C mm.	LUNGH. D mm.
0250	0250	0250	250	122	739	989
0470	0470	0470	470	71	902	1372