

TARGET J10



Interzum Award:
Intelligent material & design 2017

High Product Quality



15 - 25 mm



4

INSTALLATION

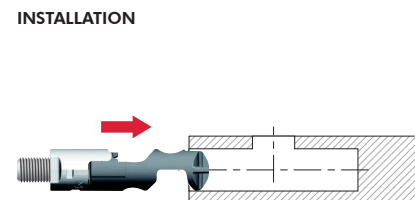

VERY IMPORTANT
Insert TARGET connecting with
countersunk hole on top.

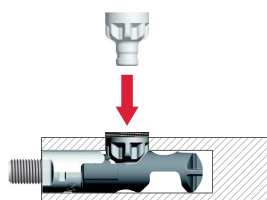
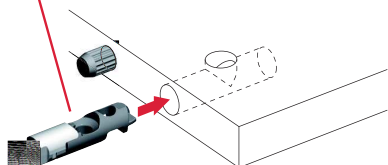

Place the pinion screw from
above.

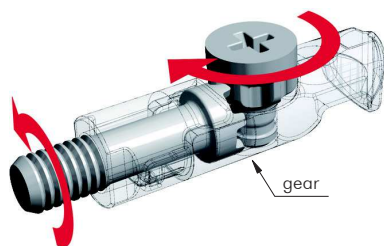
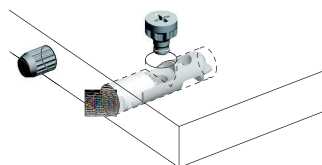

By turning the pinion
screw, the threaded dowel
makes a synchronized
rotation.

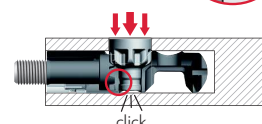
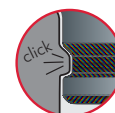

Press strongly with PZ2 cross screwdriver
to slot the pinion screw in.

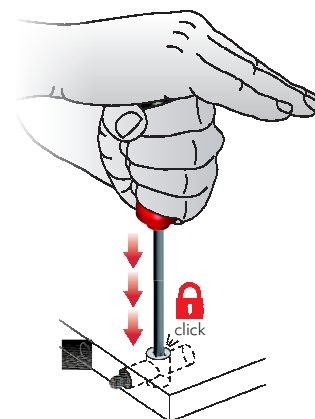

ASSEMBLING



VERY IMPORTANT

Cordless driver drill
to be used **ONLY** with
friction mode on.

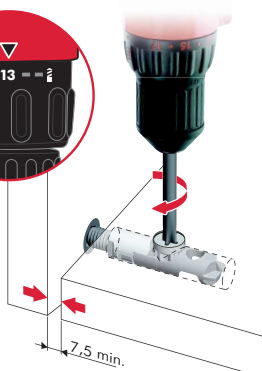
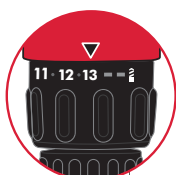

7,5 min.

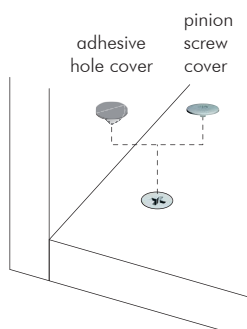

LEVELLER ADJUSTMENT

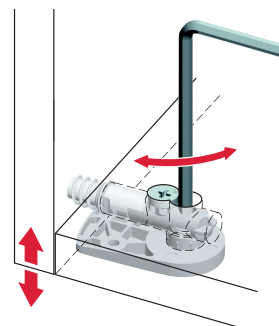

For details refer to the related section
about adjustable feet available.

TARGET J10

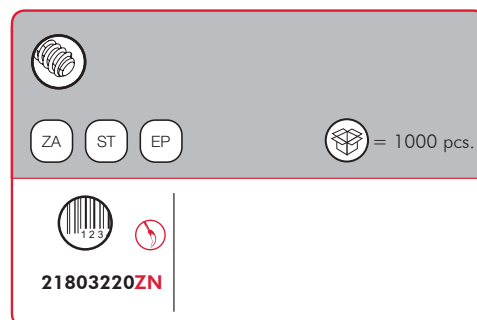
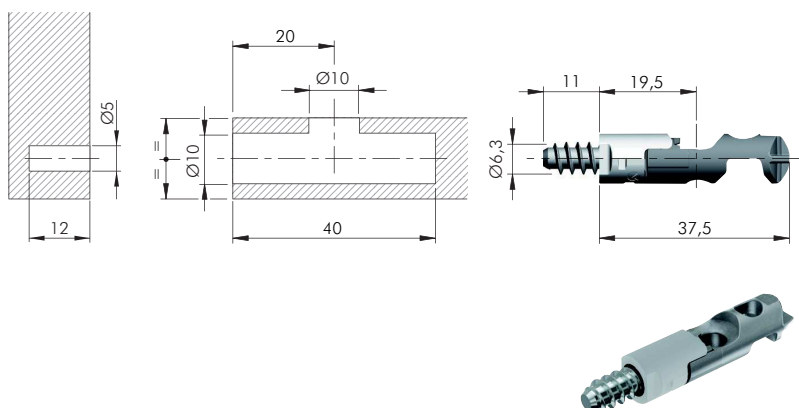
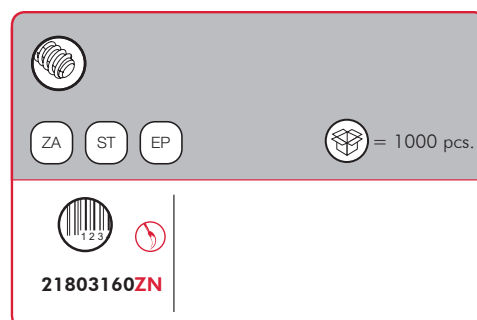
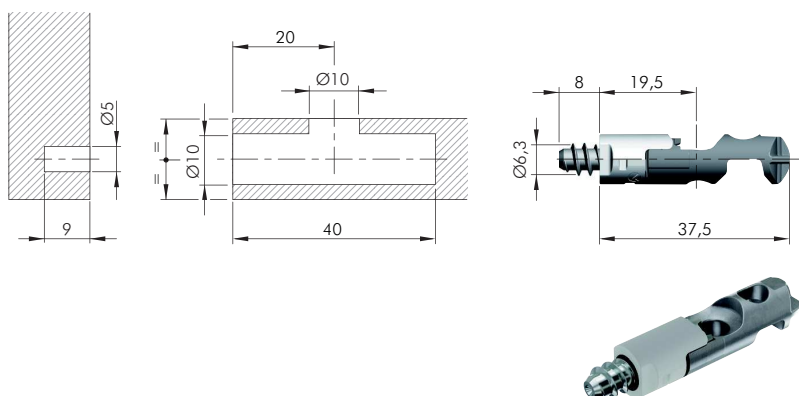
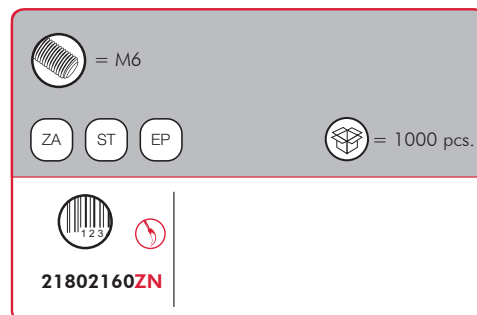
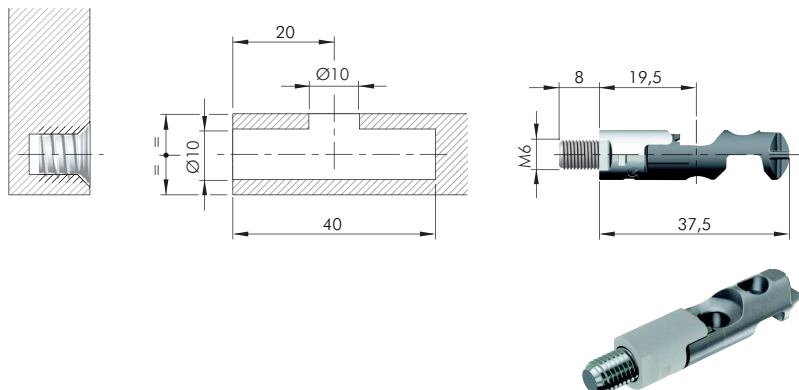

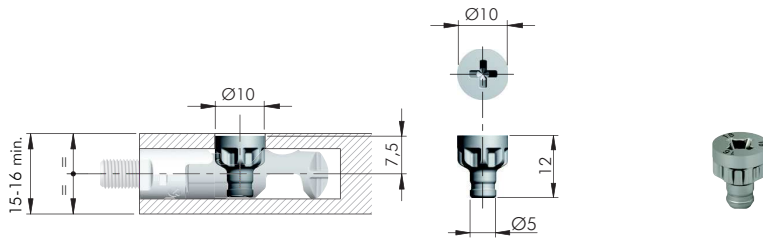

= PZ2 = Ø 10 mm
 = 15-16 mm min.
 ST = 2000 pcs.
21821160YA

4

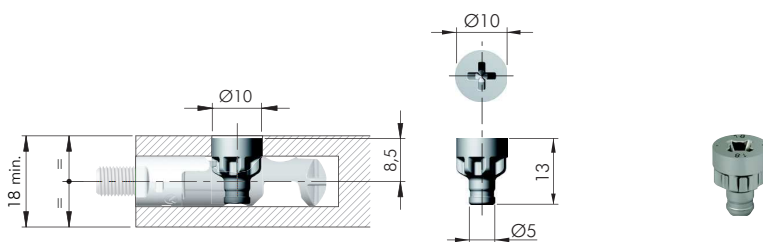

= PZ2 = Ø 10 mm
 = 18 mm min.
 ST = 2000 pcs.
21821180YA

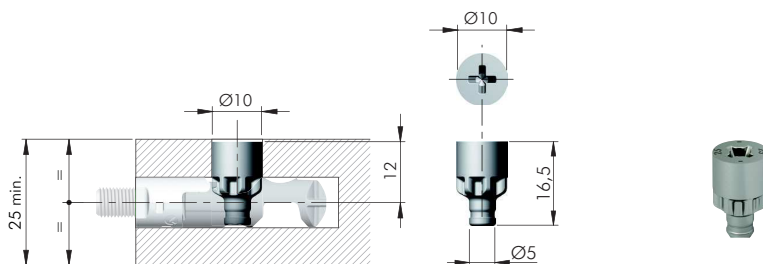

= PZ2 = Ø 10 mm
 = 25 mm min.
 ST = 2000 pcs.
21821250YA



All information about drilling jigs are available at the end of the section Target.