



K12 SYSTEM DROP DOWN



REGISTERED DESIGN
EN 15828/2010



BRACKET Ø15 INSTALLATION

- For details refer to "K12 SYSTEM BRACKETS".

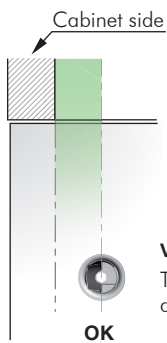

VERY IMPORTANT

The door bracket has to be aligned with the cabinet side.

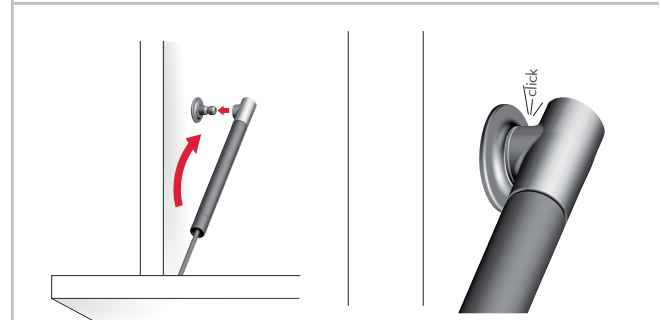
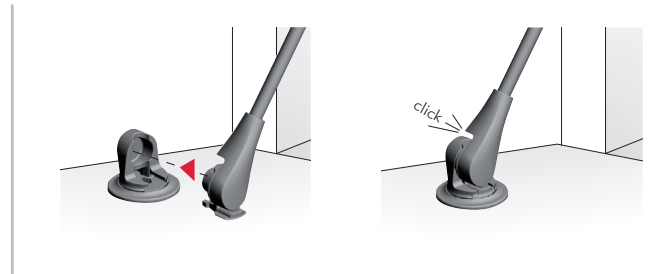
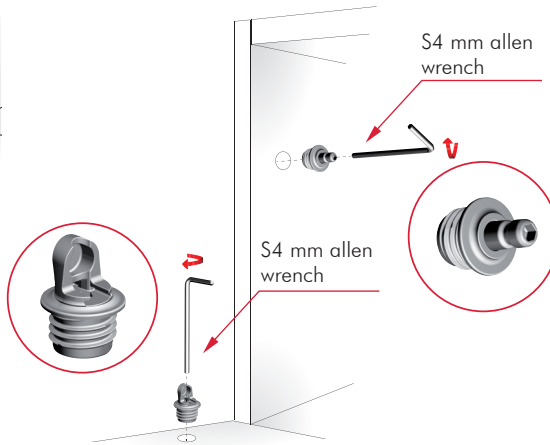

8

SCREW FIXING BRACKETS INSTALLATION

- For details refer to "K12 SYSTEM BRACKETS".

recommended fixing
countersunk head wood
screws Ø3,5x16 mm

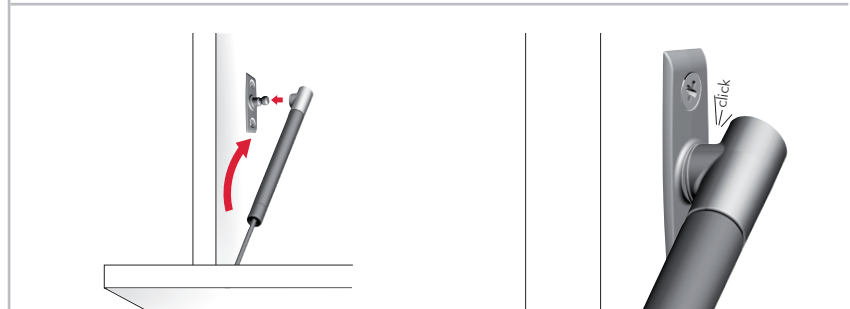
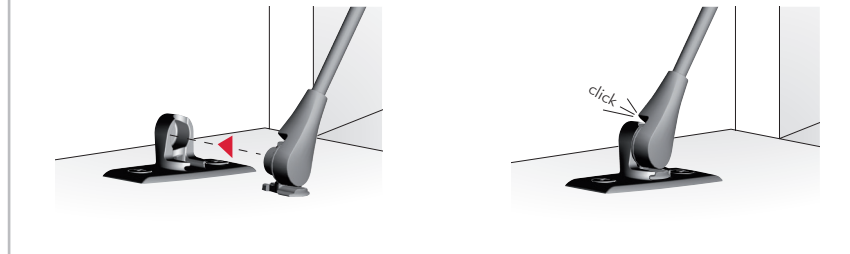
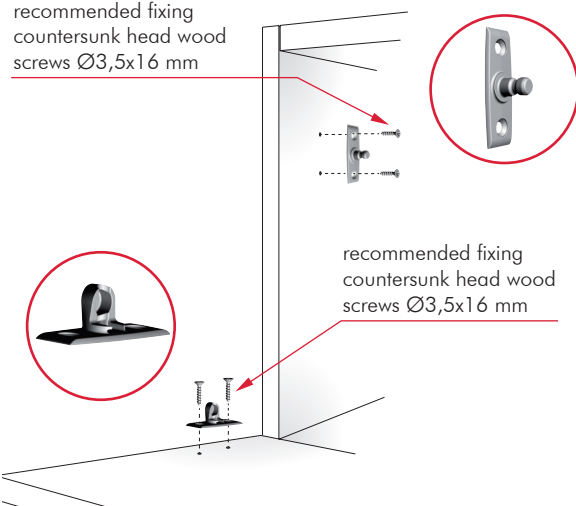



K12 SYSTEM ADJ DROP DOWN



BRACKET Ø15 INSTALLATION

- For details refer to "K12 SYSTEM ADJ BRACKETS".

8

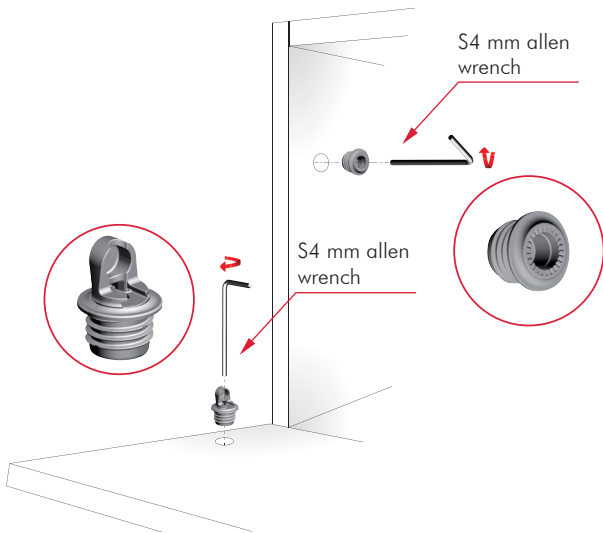

Cabinet side

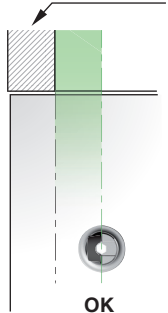

VERY IMPORTANT
The door bracket has to be aligned with the cabinet side.

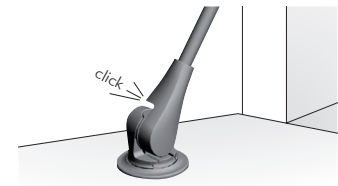

LOCKING: Rotate the plastic knob.

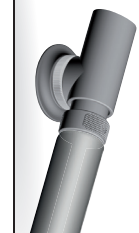
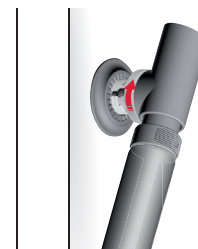
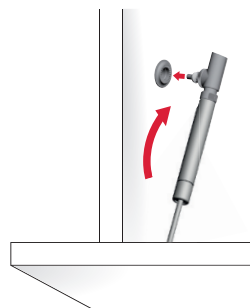

ADJUSTMENT

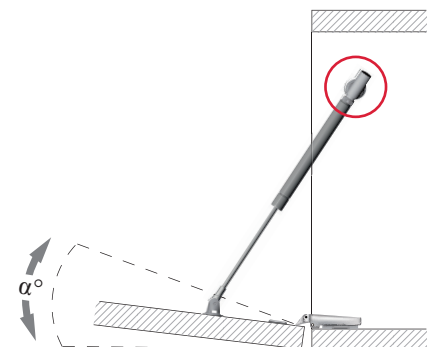
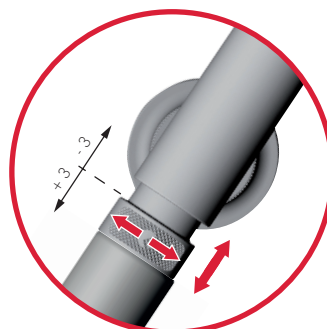



K12 SYSTEM DROP DOWN

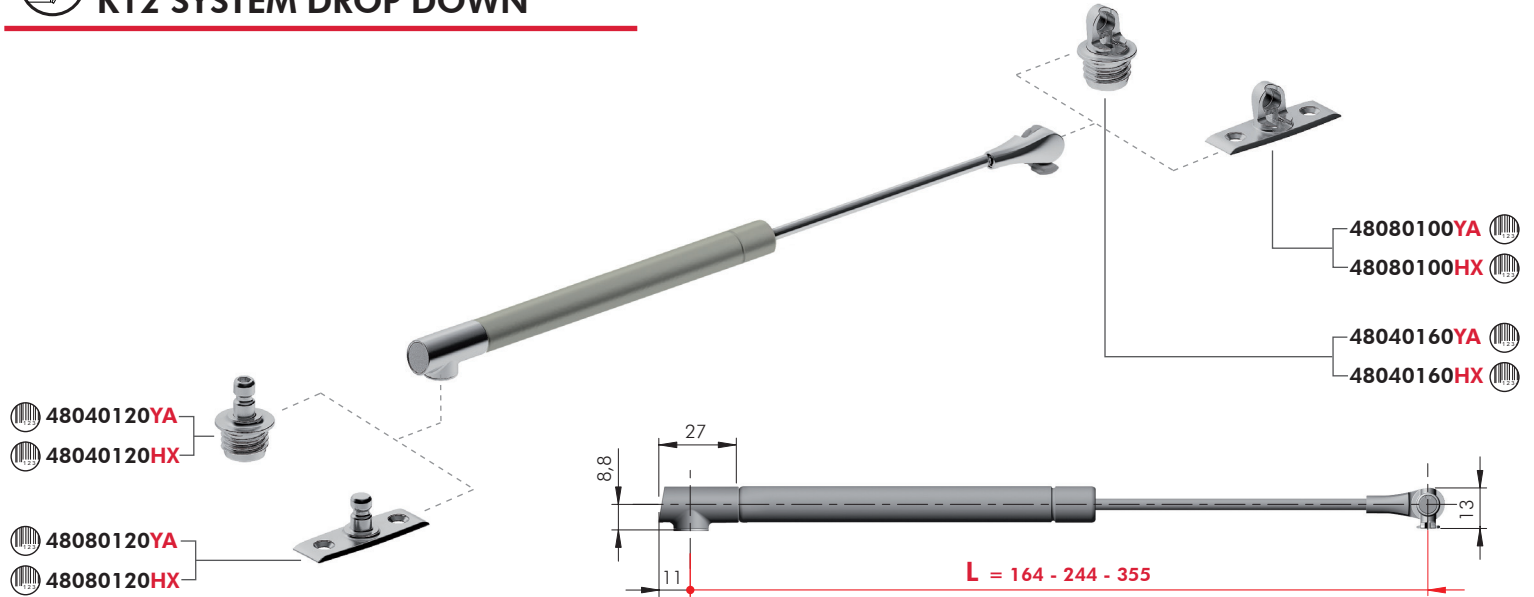

K12 SYSTEM ADJ DROP DOWN

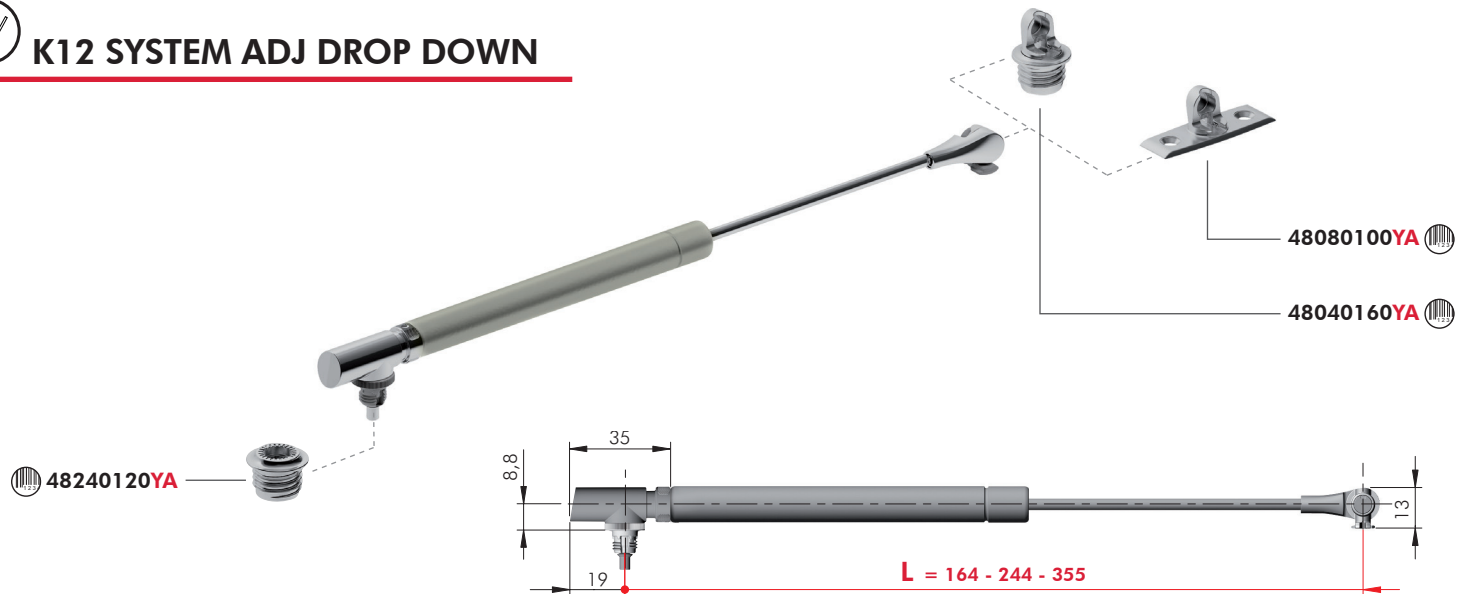

ZA EP ST

= 100 pcs. for L. 164 mm
50 pcs. for L. 244 and 355 mm

L	K12 SYSTEM	K12 SYSTEM ADJ
164	48050200UZ	48250200UZ
244	48060200UZ	48260200UZ
355	48070200UZ	48270200UZ

+ Part.no + HX

+ Part.no + HX = K12 System with end parts in graphite finish are available on request.

Number of stays chart - L 164 mm

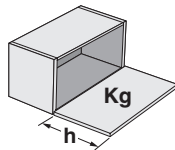

Rev. 02

h	Door weight (Kg)					
	1	2	3	4	5	6
200 - 224	1 x K12		2 x K12			
225 - 274	1 x K12		2 x K12			3 x K12
275 - 300	1 x K12		2 x K12		3 x K12	

Number of stays chart - L 244 mm

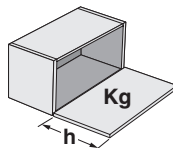

Rev. 02

h	Door weight (Kg)												
	1	2	3	4	5	6	7	8	9	10	11	12	13
290 - 324	1 x K12		2 x K12					3 x K12				4 x K12	
325 - 374	1 x K12		2 x K12					3 x K12				4 x K12	
375 - 424	1 x K12		2 x K12			3 x K12				4 x K12			
425 - 474	1 x K12		2 x K12		3 x K12			4 x K12				-	
475 - 500	1 x K12		2 x K12		3 x K12		4 x K12			-			

8

Number of stays chart - L 355 mm

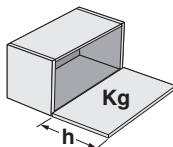

Rev. 02

h	Door weight (Kg)												
	1	2	3	4	5	6	7	8	9	10	11	12	13
390 - 424	-		1 x K12			2 x K12					3 x K12		
425 - 474	-		1 x K12			2 x K12					3 x K12		
475 - 524	-		1 x K12			2 x K12					3 x K12		
525 - 574	-		1 x K12			2 x K12			3 x K12				
575 - 600	1 x K12			2 x K12				3 x K12					4 x K12

These are experimental results to be checked by the customer. **In accordance with the actual European regulation, we suggest to use at least two stays for each door.** Our technical department is at your disposal to test further cases out of this chart.





K12 SYSTEM CONFIGURATOR:

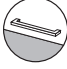

DROP DOWN DRILLING PLANS WITH KIMANA HINGE

L 164 mm

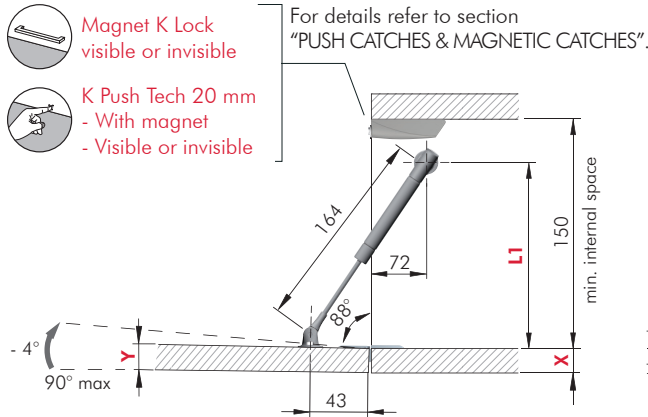

-  Magnet K Lock
visible or invisible
-  K Push Tech 20 mm
- With magnet
- Visible or invisible

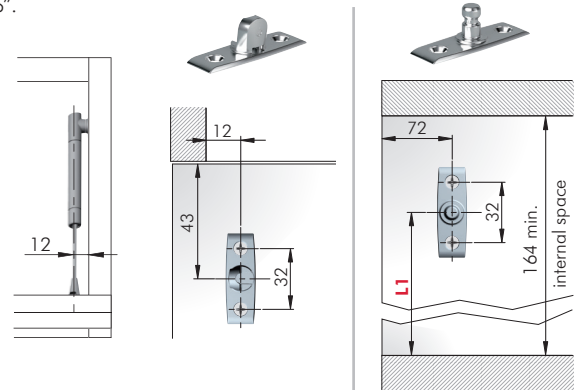

SCREW FIXING BRACKETS:



Opening angle adjustment is possible only with K12 SYSTEM ADJ version.
 ⚠ Overcrossing 90° door opening angle, it negatively effects the Kimana hinges.

Cabinet (X)		Door (Y)		L1
16 mm	4 mm	16 mm	2 mm	129
16 mm	4 mm	19 mm	-	131
18 mm	2 mm	18 mm	-	129
19 mm	-	16 mm	2 mm	125
19 mm	-	19 mm	-	127
20 mm	-	20 mm	-	127

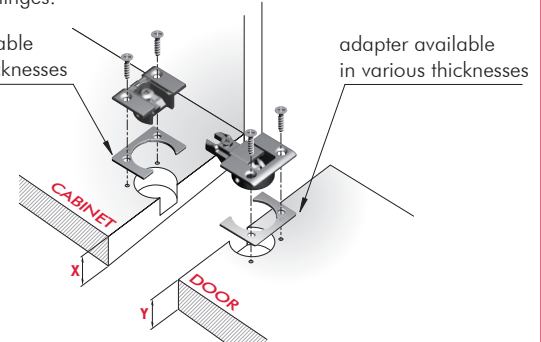

adapter available in various thicknesses



Bracket not available for K12 SYSTEM ADJ

For Kimana and adapter details refer to section "HINGES".

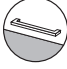
L 244 mm

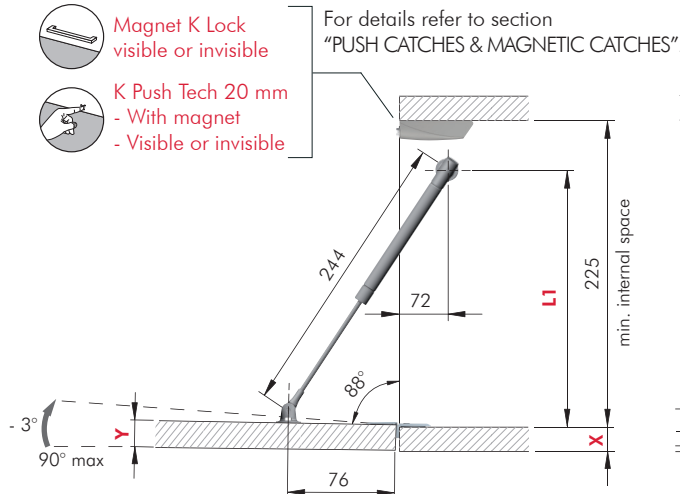

-  Magnet K Lock
visible or invisible
-  K Push Tech 20 mm
- With magnet
- Visible or invisible

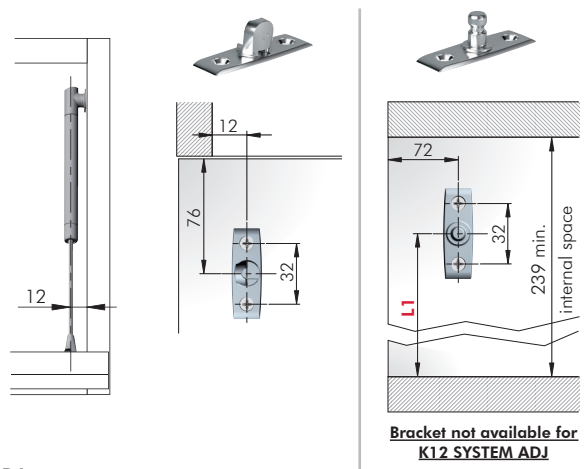

SCREW FIXING BRACKETS:



Opening angle adjustment is possible only with K12 SYSTEM ADJ version.
 ⚠ Overcrossing 90° door opening angle, it negatively effects the Kimana hinges.

Cabinet (X)		Door (Y)		L1
16 mm	4 mm	16 mm	2 mm	208
16 mm	4 mm	19 mm	-	210
18 mm	2 mm	18 mm	-	208
19 mm	-	16 mm	2 mm	204
19 mm	-	19 mm	-	206
20 mm	-	20 mm	-	206

adapter available in various thicknesses

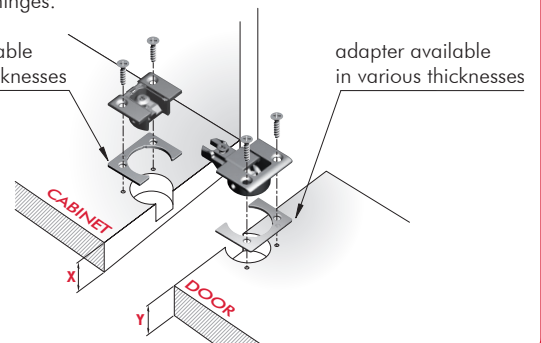

Bracket not available for K12 SYSTEM ADJ

For Kimana and adapter details refer to section "HINGES".

L 355 mm

 Magnet K Lock
visible or invisible

 K Push Tech 20 mm
- With magnet
- Visible or invisible

For details refer to section
"PUSH CATCHES & MAGNETIC CATCHES".

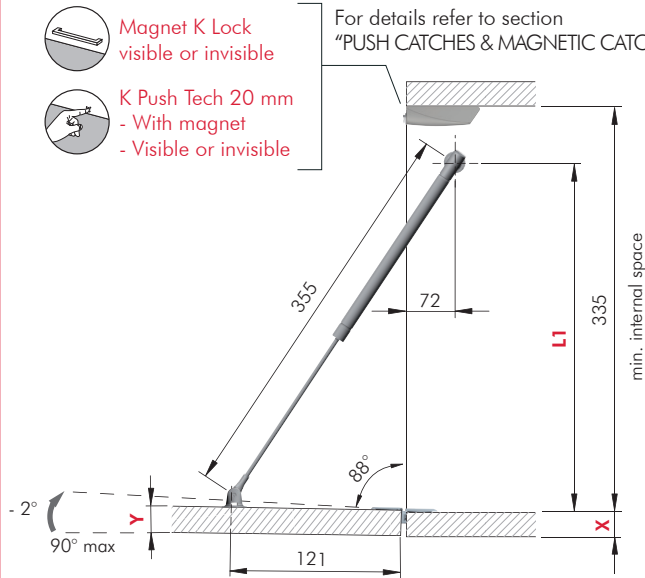

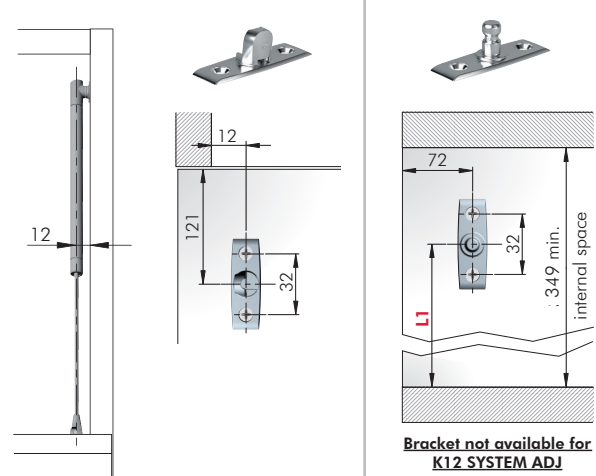

SCREW FIXING BRACKETS:



Opening angle adjustment is possible only with K12 SYSTEM ADJ version.

 Overcrossing 90° door opening angle, it negatively effects the Kimana hinges.

Cabinet (X)		Door (Y)		L1
16 mm	4 mm	16 mm	2 mm	314
16 mm	4 mm	19 mm	-	316
18 mm	2 mm	18 mm	-	314
19 mm	-	16 mm	2 mm	310
19 mm	-	19 mm	-	312
20 mm	-	20 mm	-	312

adapter available
in various thicknesses

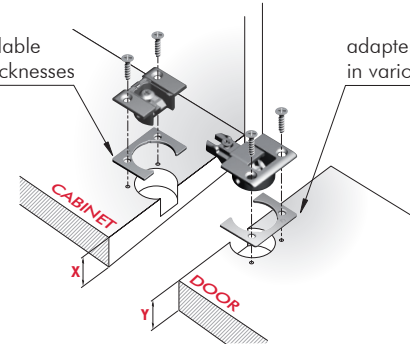

adapter available
in various thicknesses

For Kimana and adapter details refer to section "HINGES".



DROP DOWN DRILLING PLANS WITH STANDARD HINGES OPENING WITH HANDLE

K12 SYSTEM
CONFIGURATOR:

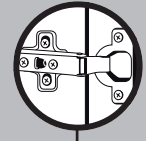
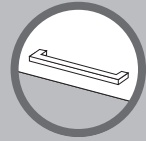

L 164 mm

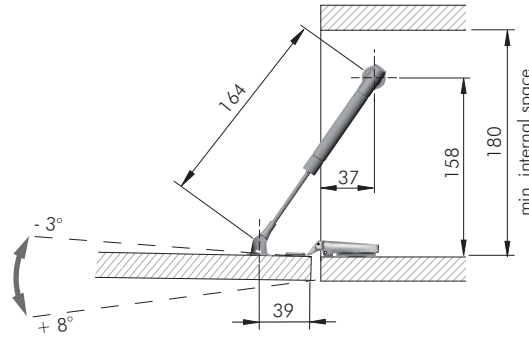

Opening angle adjustment is possible only with K12 SYSTEM ADJ version.

SCREW FIXING BRACKETS:

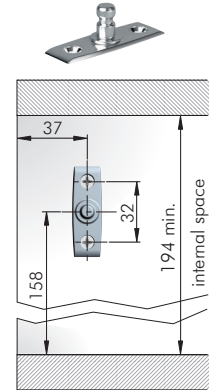
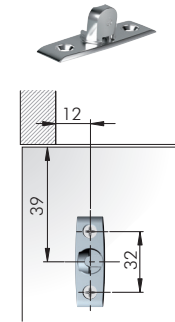

Bracket not available for K12 SYSTEM ADJ

L 244 mm

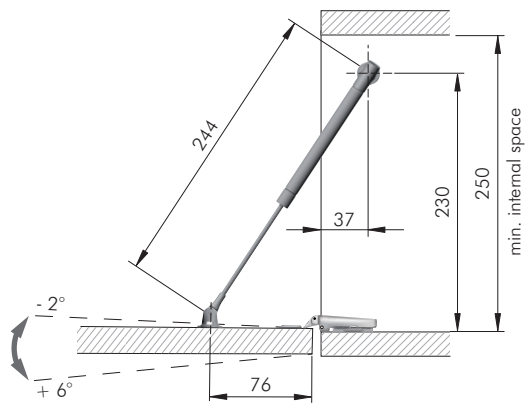

Opening angle adjustment is possible only with K12 SYSTEM ADJ version.

SCREW FIXING BRACKETS:

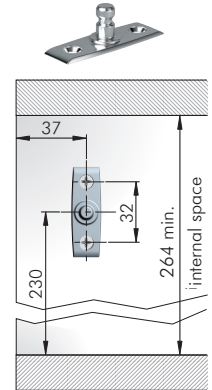
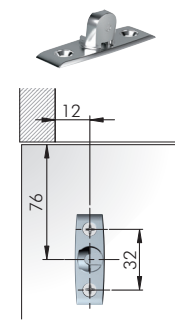

Bracket not available for K12 SYSTEM ADJ

L 355 mm

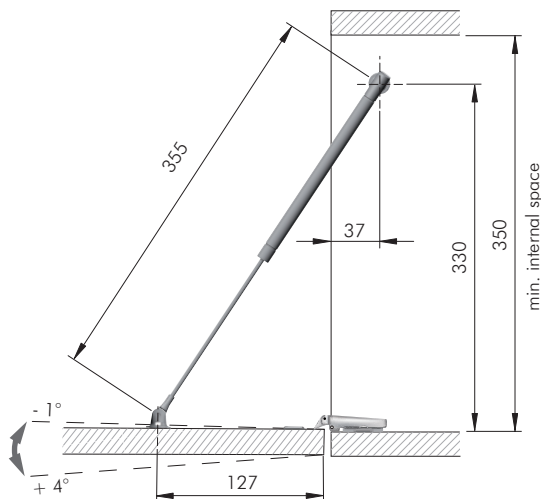

Opening angle adjustment is possible only with K12 SYSTEM ADJ version.

SCREW FIXING BRACKETS:

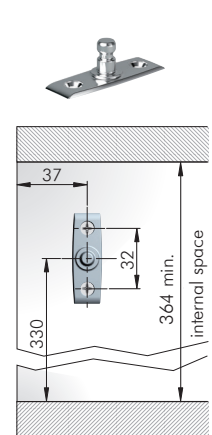
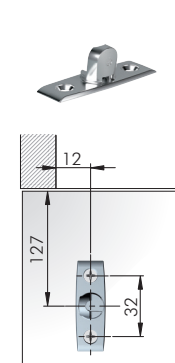

Bracket not available for K12 SYSTEM ADJ

The dimensions of the drilling plans refer to carcasses which use **standard sprung hinges** and mounting plates 0 mm. Please note that the opening angle varies with respect to the hinge brand and adjustment carried out.

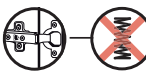

Please note that in case of use of **unsprung hinges**, magnet **K Lock** is required. For details refer to section "PUSH CATCHES & MAGNETIC CATCHES".

K12 SYSTEM CONFIGURATOR:



DROP DOWN DRILLING PLANS WITH STANDARD HINGES PUSH TO OPEN

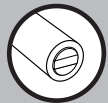
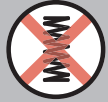
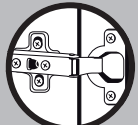

L 164 mm

K Push Tech 14 mm
- With magnet
- Visible or invisible

For details refer to section "PUSH CATCHES & MAGNETIC CATCHES".

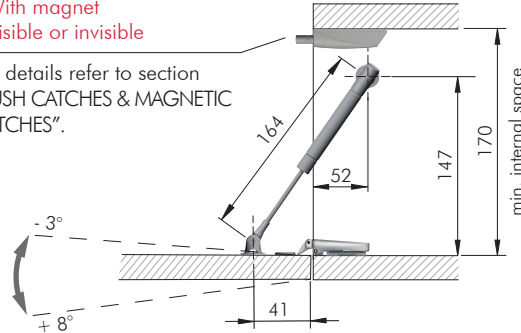

Opening angle adjustment is possible only with K12 SYSTEM ADJ version.

SCREW FIXING BRACKETS:

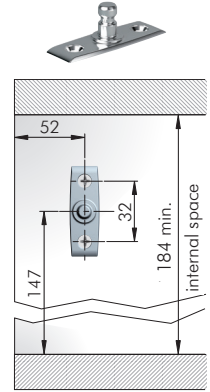
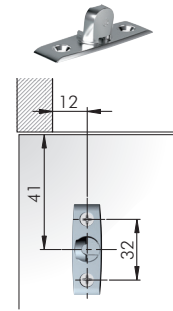

Bracket not available for K12 SYSTEM ADJ

L 244 mm

K Push Tech 14 mm
- With magnet
- Visible or invisible

For details refer to section "PUSH CATCHES & MAGNETIC CATCHES".

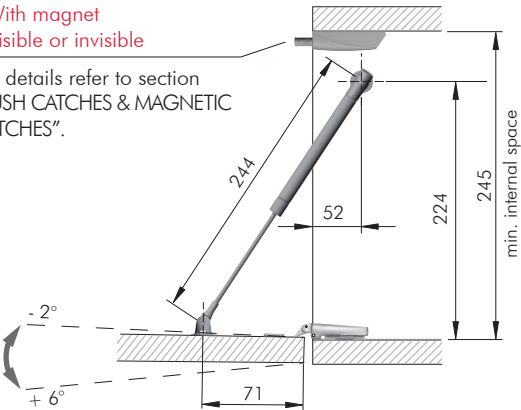

Opening angle adjustment is possible only with K12 SYSTEM ADJ version.

SCREW FIXING BRACKETS:

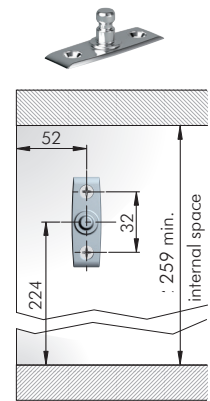
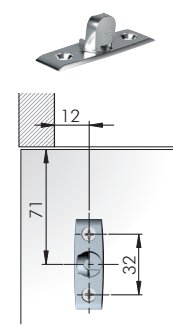

Bracket not available for K12 SYSTEM ADJ

L 355 mm

K Push Tech 14 mm
- With magnet
- Visible or invisible

For details refer to section "PUSH CATCHES & MAGNETIC CATCHES".

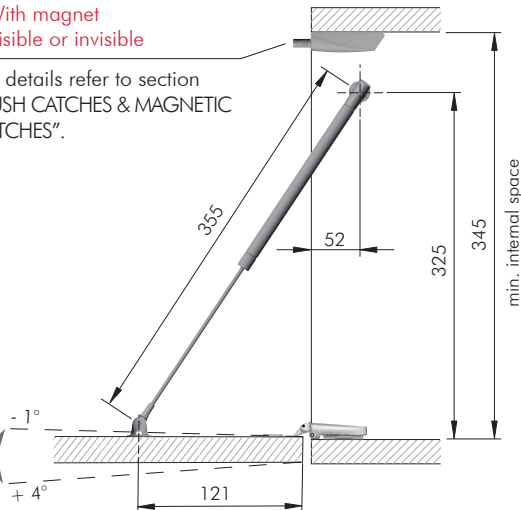

Opening angle adjustment is possible only with K12 SYSTEM ADJ version.

SCREW FIXING BRACKETS:

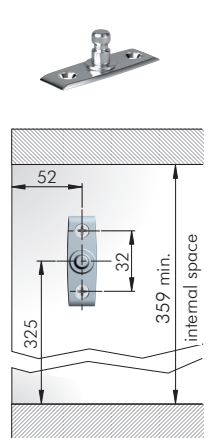
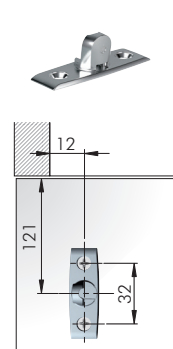

Bracket not available for K12 SYSTEM ADJ

The dimensions of the drilling plan refer to carcasses which use **standard unsprung hinges** and mounting plates 0 mm. Please note that the opening angle varies with respect to the hinge brand and adjustment carried out.

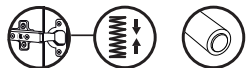

Please note that utilization with **standard sprung hinges** and **K Push Tech with buffer** is also possible. In such case, after the door is initially released by K Push Tech, a manual opening approx. 7cm is required (in order to win the spring resistance). Consequently, the door will automatically open to the fullest. For details refer to section "PUSH CATCHES & MAGNETIC CATCHES".



DROP DOWN DRILLING PLANS WITH FLAP HINGE

K12 SYSTEM CONFIGURATOR:



L 164 mm

Magnet K Lock
visible or invisible

K Push Tech 20 mm
- With magnet
- Visible or invisible

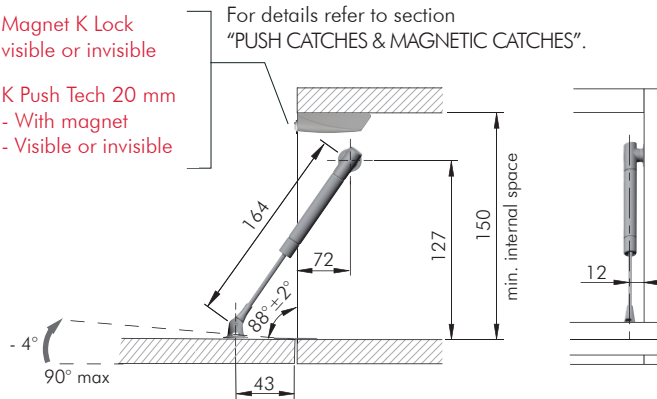

Opening angle adjustment is possible only with K12 SYSTEM ADJ version.

Overcrossing 90° door opening angle, it negatively effects the flap hinges.

SCREW FIXING BRACKETS:

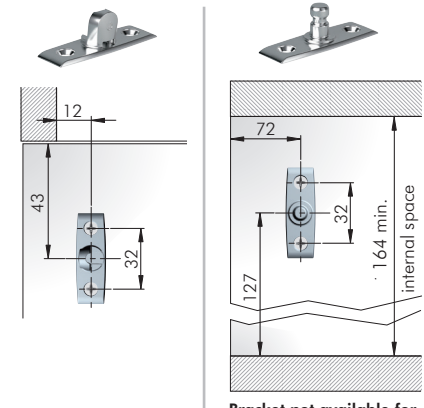

Bracket not available for K12 SYSTEM ADJ

L 244 mm

Magnet K Lock
visible or invisible

K Push Tech 20 mm
- With magnet
- Visible or invisible

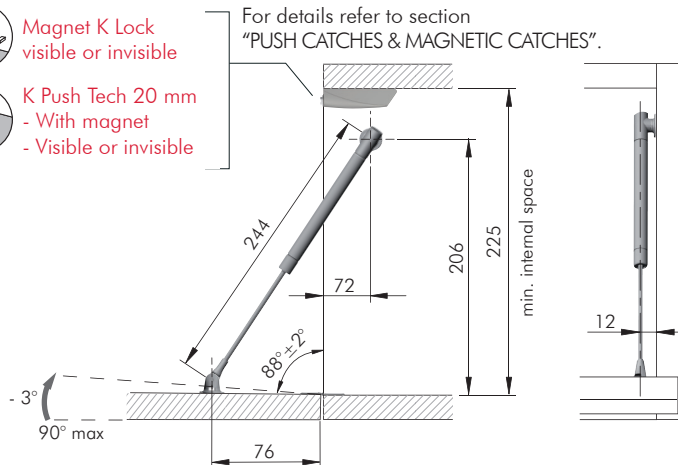

Opening angle adjustment is possible only with K12 SYSTEM ADJ version.

Overcrossing 90° door opening angle, it negatively effects the flap hinges.

SCREW FIXING BRACKETS:

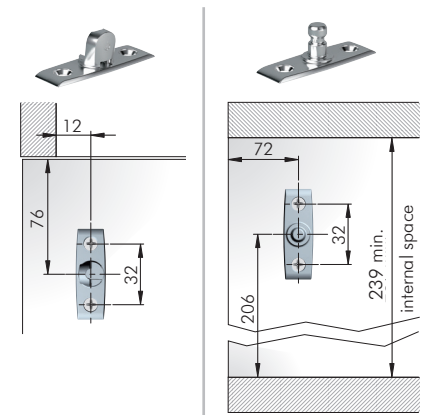

Bracket not available for K12 SYSTEM ADJ

L 355 mm

Magnet K Lock
visible or invisible

K Push Tech 20 mm
- With magnet
- Visible or invisible

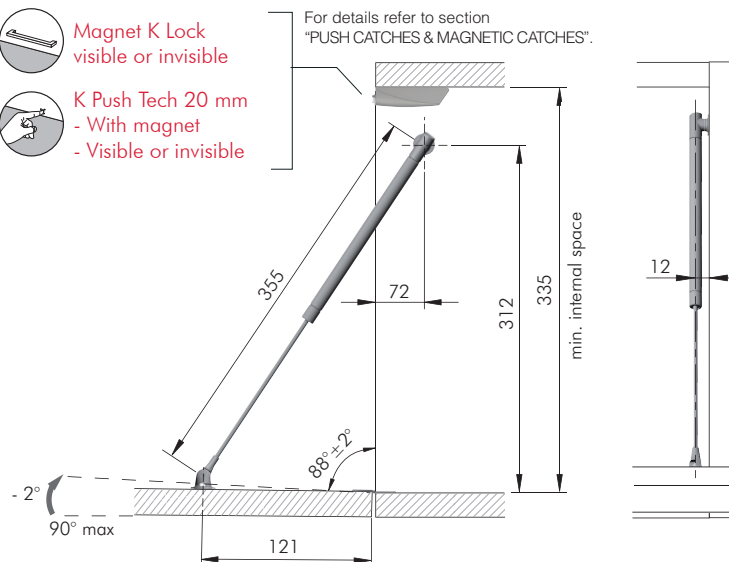

Opening angle adjustment is possible only with K12 SYSTEM ADJ version.

Overcrossing 90° door opening angle, it negatively effects the flap hinges.

SCREW FIXING BRACKETS:

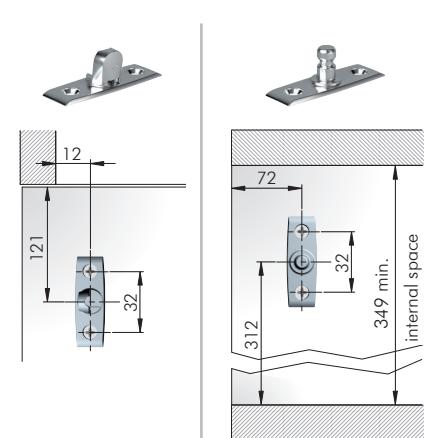

Bracket not available for K12 SYSTEM ADJ

The dimensions of the drilling plan refer to carcasses which use flap hinges.

DRILLING PLANS FOR BRACKETS

SIDE BRACKET Ø15 - K12 SYSTEM

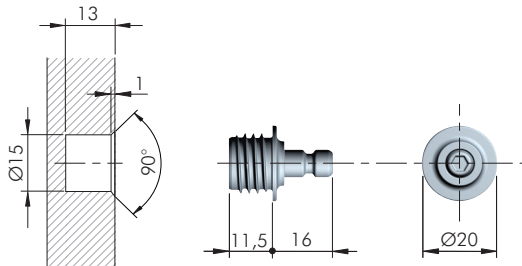

= Ø 15 mm



ZA



= 50 pcs.



48040120YA

48040120HX

SIDE BRACKET Ø15 - K12 SYSTEM ADJ

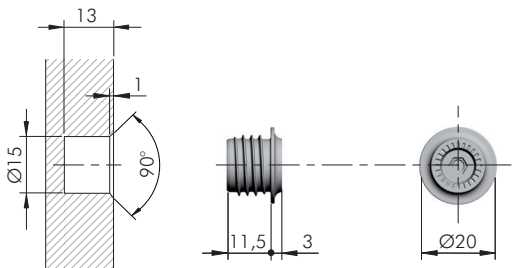

= Ø 15 mm



ZA



= 50 pcs.



48240120YA

8

DOOR BRACKET Ø15

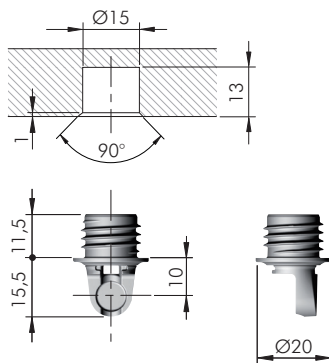

= Ø 15 mm



ZA



= 50 pcs.



48040160YA

48040160HX



SCREW FIXING SIDE BRACKET (Not for K12 SYSTEM ADJ)

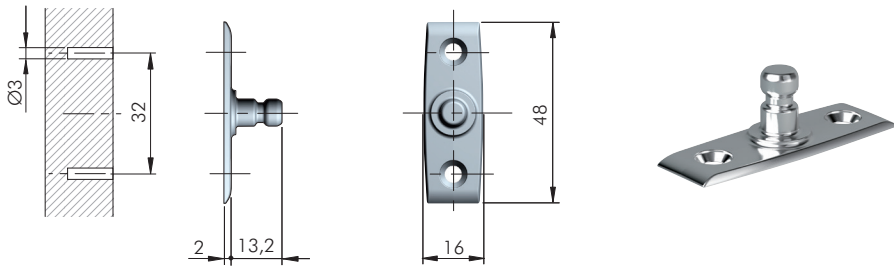

= Ø 3 mm

ZA

= 50 pcs.



48080120YA

48080120HX

SCREW FIXING DOOR BRACKET

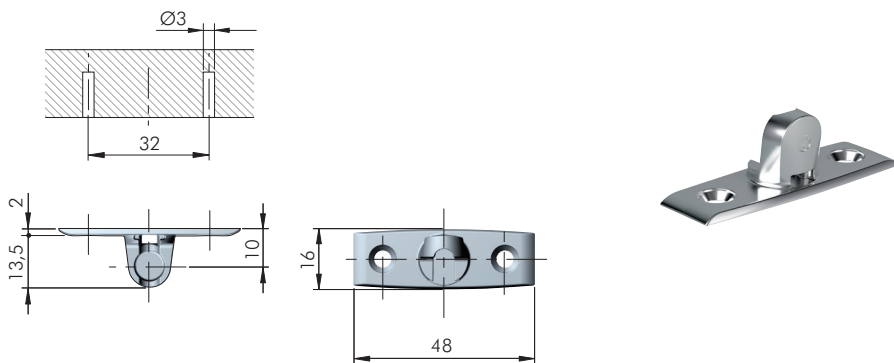

= Ø 3 mm

ZA

= 50 pcs.



48080100YA

48080100HX

SCREW FIXING BRACKETS ACCESSORY



= Ø 3 mm



= PZ2

ST

= 10.000 pcs.



60101390YA

60101390HX

ADAPTERS FOR ALUMINIUM FRAME DOOR



INSTALLATION ON WIDER ALUMINIUM FRAME DOOR



INSTALLATION ON NARROW ALUMINIUM FRAME DOOR

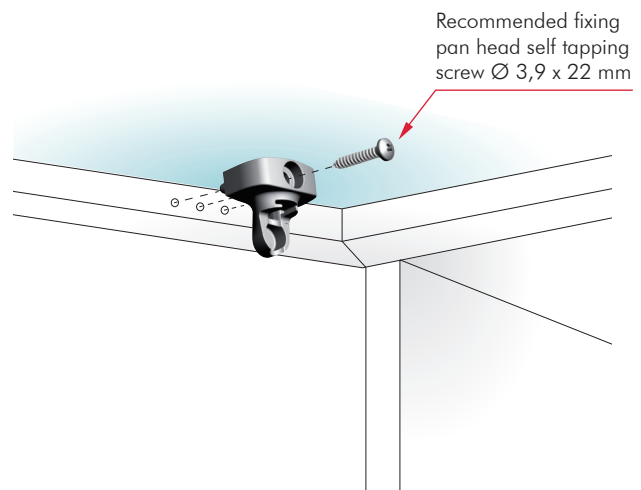
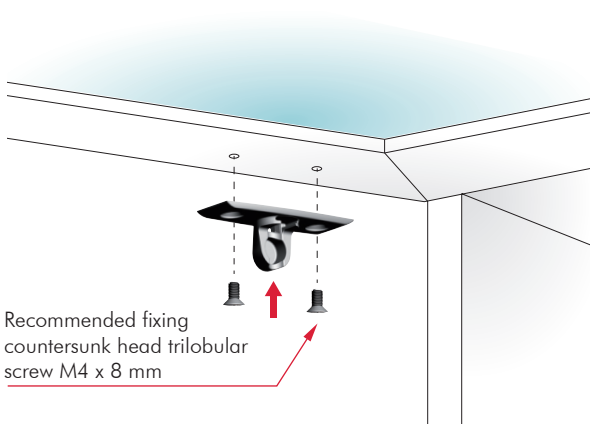

8

WIDER ALUMINIUM FRAME DOOR (40 mm min.)

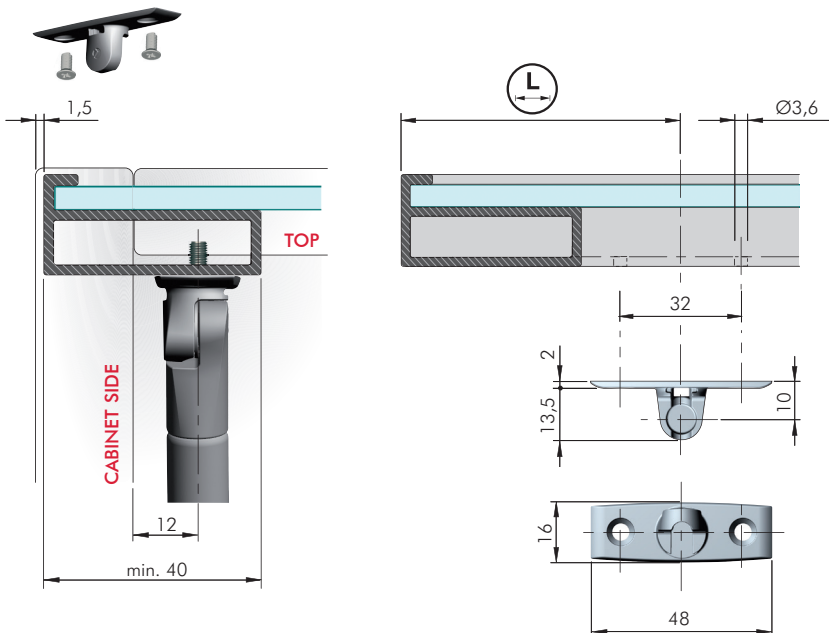

	= Ø 3,6 mm		= 50 pcs.
48080100YA			



NARROW ALUMINIUM FRAME DOOR (20 mm) WITH SIDE PANEL THICKNESS 16 mm

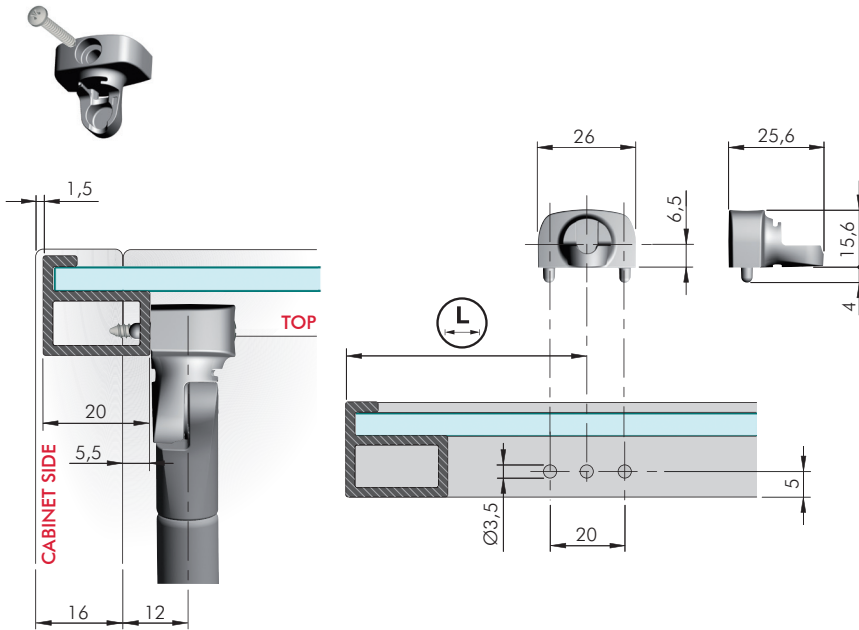

= Ø 3,5 mm
 = on request
 123

48080140YA

NARROW ALUMINIUM FRAME DOOR (20 mm) WITH SIDE PANEL THICKNESS 18 mm

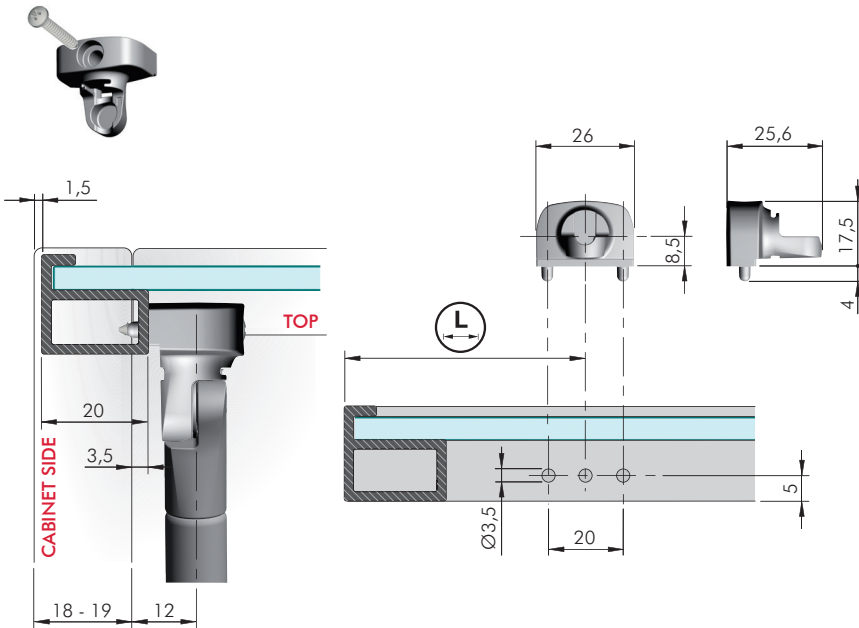

= Ø 3,5 mm
 = on request
 123

48080150YA

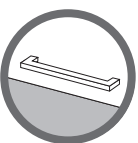

K12 System & K12 System ADJ	
164	39
244	76
355	127



K12 System & K12 System ADJ	
164	41
244	71
355	121



K12 System & K12 System ADJ	
164	43
244	76
355	121

For details refer to related sections.



ALUMINIUM ADAPTERS FIXING ACCESSORIES

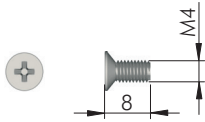

= PZ2

ST

= on request



42906010YA

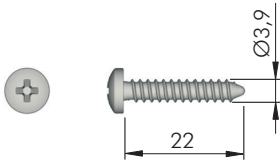

= PZ2

ST

= on request



60203390YA