

STILE

Chain actuator – Force 300 N – Stroke 400 mm



PATENTED CHAIN ACTUATOR

- Double link chain for a better load resistance in case of top hinged windows, heavy windows or roof windows.
- Two available versions: **STILE** with a selectable stroke /400 mm and **STILE R** with a maximum stroke of 400 mm, adjustable from 0 to 300 mm, by positioning a magnet on the chain during installation.
- Glass strengthened nylon casing.
- Double electric insulation actuator (no electric connection to earth is needed).
- The special removable plug allows a very quick and easy connection. It is ideal for the final test of the actuators on the building site.
- Exclusive system for a quick and safe installation.
- Quick release system for an easy window cleaning.
- Supplied with pivoting brackets and spacer for chain connector to be used on windows with an high overlap.
- In case of vents with four –bar hinges, please contact our Technical Dept.
- Provided with closing feedback signal.



VOLTAGE SUPPLY
ELECTRIC CONNECTION
MAXIMUM STROKE
FORCE
SPEED
CURRENT ABSORPTION (with max load)
PARALLEL CONNECTION
LIMIT STOP
PROTECTION
FEEDBACK SIGNAL
PROTECTION CLASS

STILE

230 Vac 50/60 Hz
3 wires (*)
selectable 230/400 mm
300 N (**)
~ 30 mm/s
0,8 A
YES
Micro switches
Thermic
Close
IP 20

Part No.

GRAY	41554A
BLACK	41555B
WHITE	41556C

STILE R

230 Vac 50/60 Hz
3 wires (*)
400 mm: adjustable from 0 a 300 mm
300 N (**)
~ 30 mm/s
0,8 A
YES
Micro switches/Hall sensor
Thermic
Close
IP 20

41558E
41559F
41560G

(*) Double electric insulation actuator: no electric connection to earth is needed.

(**) In case of push action and full stroke, maximum force is intended for short period only.



Accessories

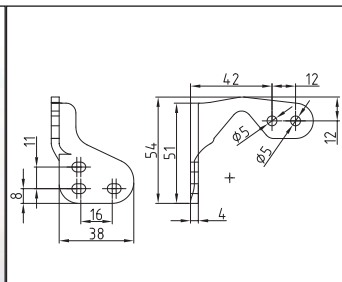

Fixing brackets (included)



Spacer for chain connector (included)



Electrical connector included (no cable)



Bottom hinged window plastic bracket
(to be ordered separately)

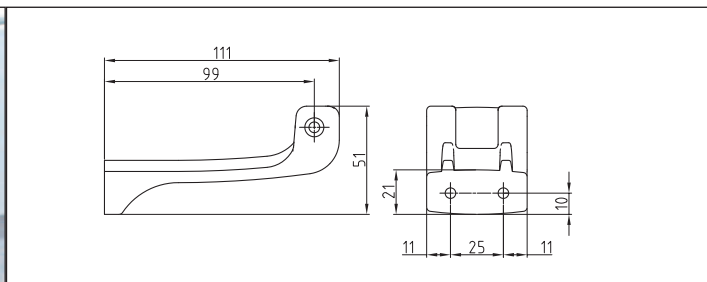

Grey: Part No. 41582C
Black: Part No. 41583D
White: Part No. 41584E



Chain connector for concealed vent
Grey: Part No. 41590K
Black: Part No. 41591L
White: Part No. 41592M

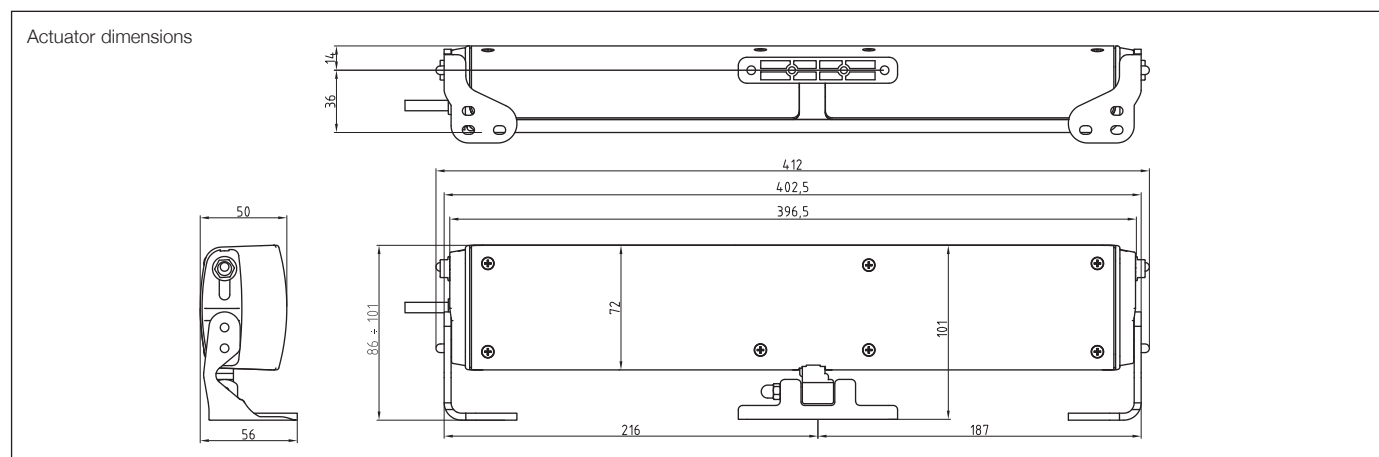

Installation examples

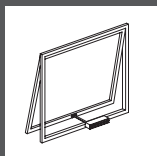

Top hi nged

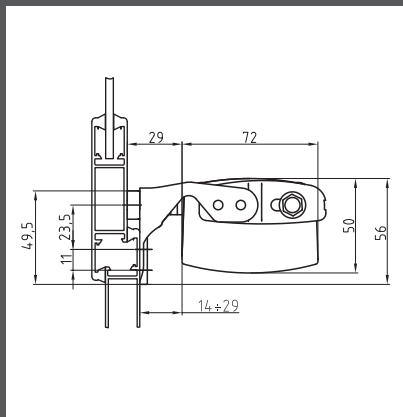

On the frame with pivoting brackets i ncl uded

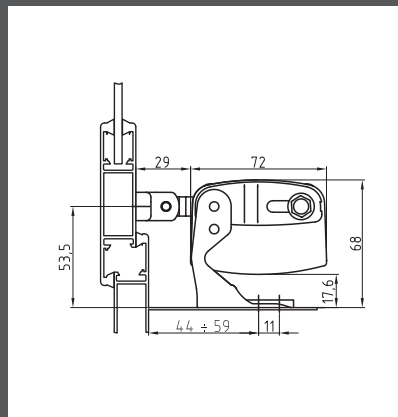

On the windowsill with pivoting brackets i ncl uded

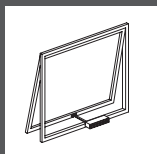

Top hi nged wi ndows with concea l ed vent

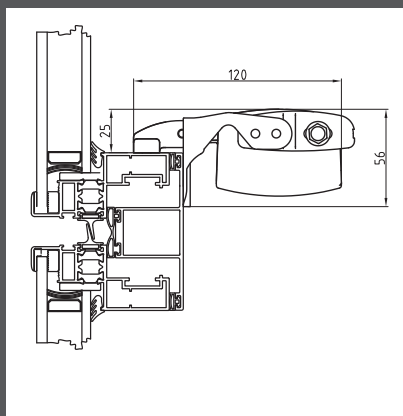

On the frame with pivoting brackets i ncl uded and chain connector f or concea l ed vents

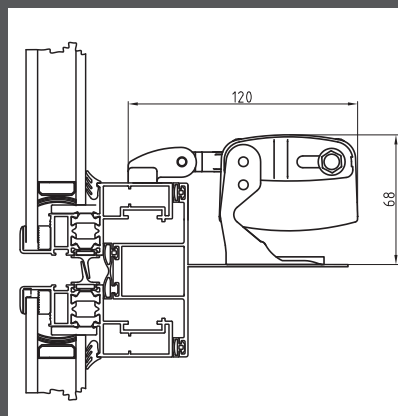

On the windowsill with pivoting brackets i ncl uded and chain connector f or concea l ed vents

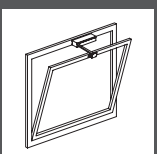

Bot t om

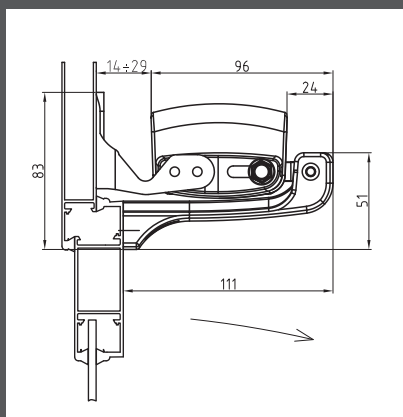
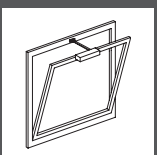

On the vent with pivoting brackets i ncl uded

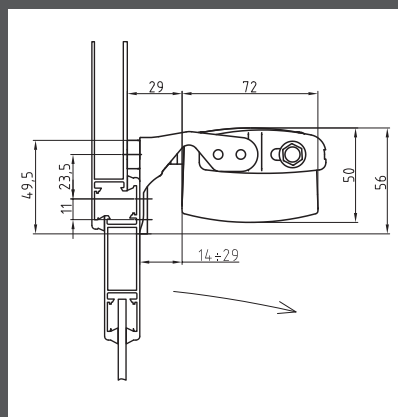

On the frame with pivoting brackets i ncl uded and bot tom hi nged bracket

 The instructions for a safe installation are included in the section “SECURITY WARNINGS”

SPECIFICATION PROSPECT

Class 2 electric insulation chain actuator Ultraflex Control Systems named Stile with double link chain in two versions:selectable stroke 230/400 mm or adjustable stroke from 0 to 300 mm. Voltage supply: 230 Vac. Parallel connection. Limit stop by micro switches and thermal protection. Plastic scratch resistant finish. Conform to 2006/95/CE LVD and 2004/108/CE EMC directives. The instructions for a safe installation are included in the section “SECURITY WARNINGS”