

STILE

Chain actuator – Force 300 N – Stroke 400 mm



PATENTED CHAIN ACTUATOR

- Double link chain for a better load resistance in case of top hinged windows, heavy windows or roof windows.
- Two available versions: **STILE** with a selectable stroke /400 mm and **STILE R** with a maximum stroke of 400 mm, adjustable from 0 to 300 mm, by positioning a magnet on the chain during installation.
- Glass strengthened nylon casing.
- Double electric insulation actuator (no electric connection to earth is needed).
- The special removable plug allows a very quick and easy connection. It is ideal for the final test of the actuators on the building site.
- Exclusive system for a quick and safe installation.
- Quick release system for an easy window cleaning.
- Supplied with pivoting brackets and spacer for chain connector to be used on windows with an high overlap.
- In case of vents with four –bar hinges, please contact our Technical Dept.
- Provided with closing feedback signal.



VOLTAGE SUPPLY
 ELECTRIC CONNECTION
 MAXIMUM STROKE
 FORCE
 SPEED
 CURRENT ABSORPTION (with max load)
 PARALLEL CONNECTION
 LIMIT STOP
 PROTECTION
 FEEDBACK SIGNAL
 PROTECTION CLASS

STILE
 230 Vac 50/60 Hz
 3 wires (*)
 selectable 230/400 mm
 300 N (**)
 ~ 30 mm/s
 0,8 A
 YES
 Micro switches
 Thermic
 Close
 IP 20

STILE R
 230 Vac 50/60 Hz
 3 wires (*)
 400 mm: adjustable from 0 a 300 mm
 300 N (**)
 ~ 30 mm/s
 0,8 A
 YES
 Micro switches/Hall sensor
 Thermic
 Close
 IP 20

Part No.

GRAY 41554A
 BLACK 41555B
 WHITE 41556C

41558E
 41559F
 41560G

(*) Double electric insulation actuator: no electric connection to earth is needed.
 (**) In case of push action and full stroke, maximum force is intended for short period only.



Accessories

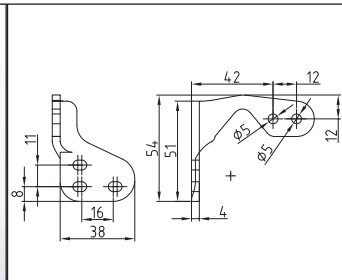

Fixing brackets (included)



Spacer for chain connector (included)

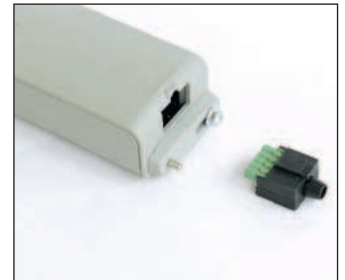

Electrical connector included (no cable)

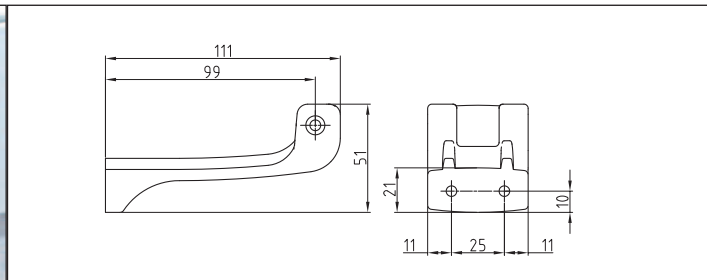

Bottom hinged window plastic bracket (to be ordered separately)

Grey: Part No. 41582C
 Black: Part No. 41583D
 White: Part No. 41584E



Chain connector for concealed vent
 Grey: Part No. 41590K
 Black: Part No. 41591L
 White: Part No. 41592M

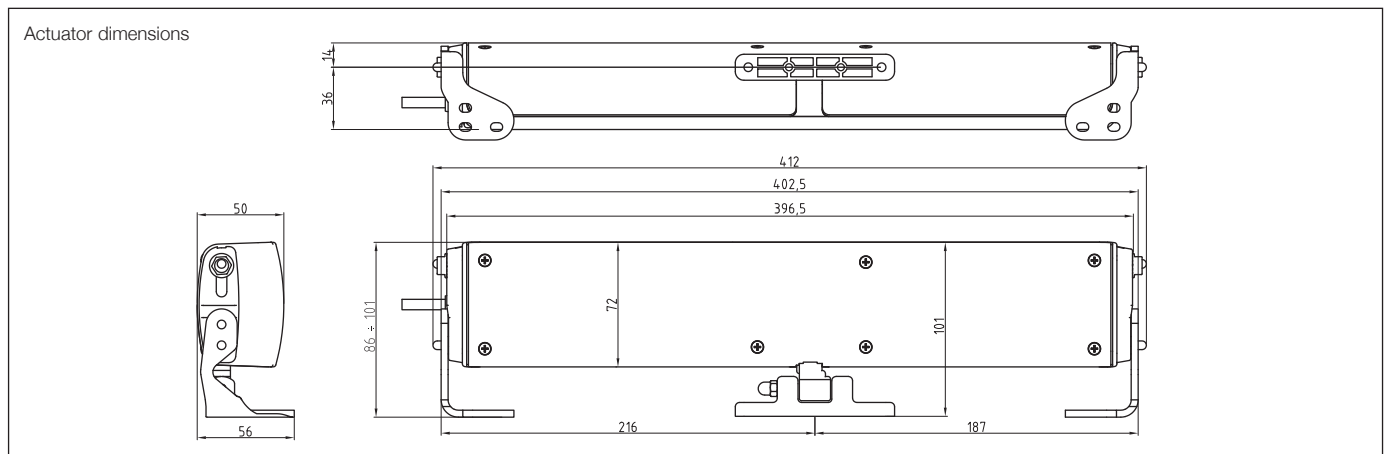

Installation examples

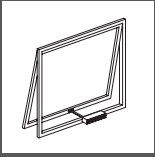

Top hinged

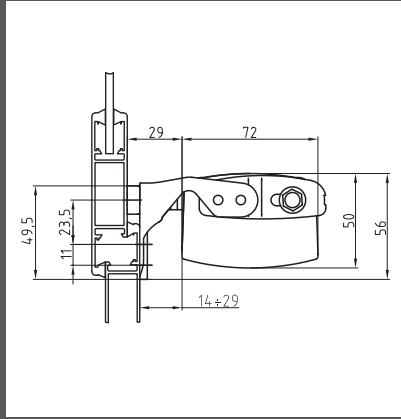

On the frame with pivoting brackets included

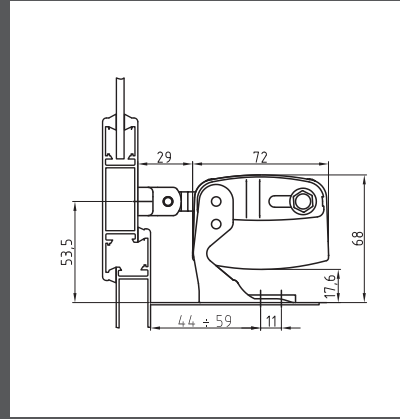

On the windowsill with pivoting brackets included

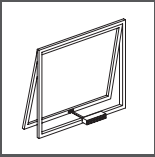

Top hinged windows with concealed vent

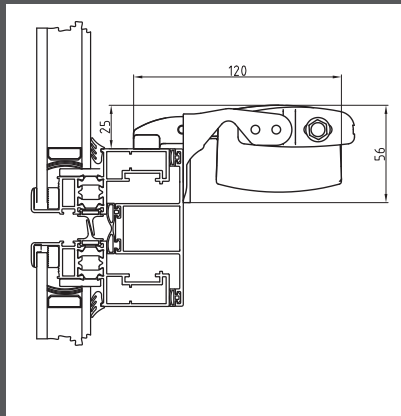

On the frame with pivoting brackets included and chain connector for concealed vents

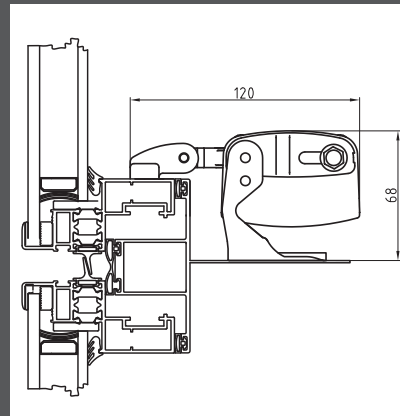

On the windowsill with pivoting brackets included and chain connector for concealed vents

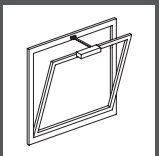
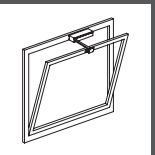

Bottom

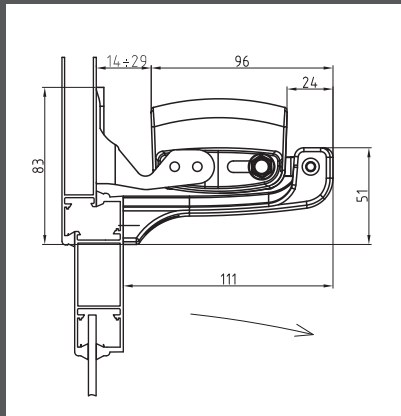

On the vent with pivoting brackets included

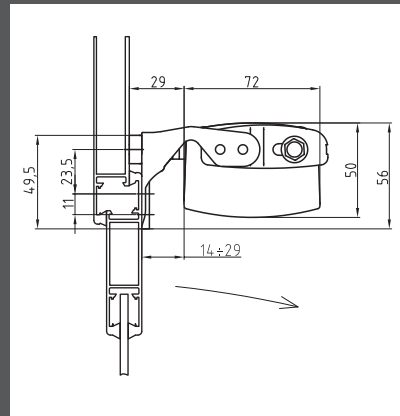

On the frame with pivoting brackets included and bottom hinged bracket

⚠ The instructions for a safe installation are included in the section "SECURITY WARNINGS"

SPECIFICATION PROSPECT

Class 2 electric insulation chain actuator Ultraflex Control Systems named Stile with double link chain in two versions:selectable stroke 230/400 mm or adjustable stroke from 0 to 300 mm. Voltage supply: 230 Vac. Parallel connection. Limit stop by micro switches and thermal protection. Plastic scratch resistant finish. Conform to 2006/95/CE LVD and 2004/108/CE EMC directives.

The instructions for a safe installation are included in the section "SECURITY WARNINGS"